



Sudoku Plaza

Explanation of Double Eight-by-Eight Sudoku.

Explanation:

This Sudoku variant has 16 rows and columns each with eight positions. In each row and column the number 1 to 8 may appear only once. Moreover this rule is used in the 16 blocks marked with a border line.

The solution looks like:

6		7	1		8	2		5	3		4
	3	1		6	5		4	8		2	7
	2	4		3	7		1	6		8	5
8		5	4		2	7		3	6		1
1		8	2		7	3		6	4		5
	7	3		1	4		2	5		6	8
	4	2		5	6		8	1		7	3
5		6	8		3	4		7	1		2
4		1	7		5	6		2	8		3
	8	5		2	1		7	3		4	6
	6	7		8	3		5	4		1	2
3		2	6		4	1		8	5		7
7		4	3		6	5		1	2		8
	5	8		4	2		6	7		3	1
	1	6		7	8		3	2		5	4
2		3	5		1	8		4	7		6

Row 1:

6		7	1		8	2		5	3		4
---	--	---	---	--	---	---	--	---	---	--	---

Row 2:

	3	1		6	5		4	8		2	7
--	---	---	--	---	---	--	---	---	--	---	---

Row 3:

	2	4		3	7		1	6		8	5
--	---	---	--	---	---	--	---	---	--	---	---

Etc.



Sudoku Plaza

Column 1: Column 2: Column 3: enzovoort.

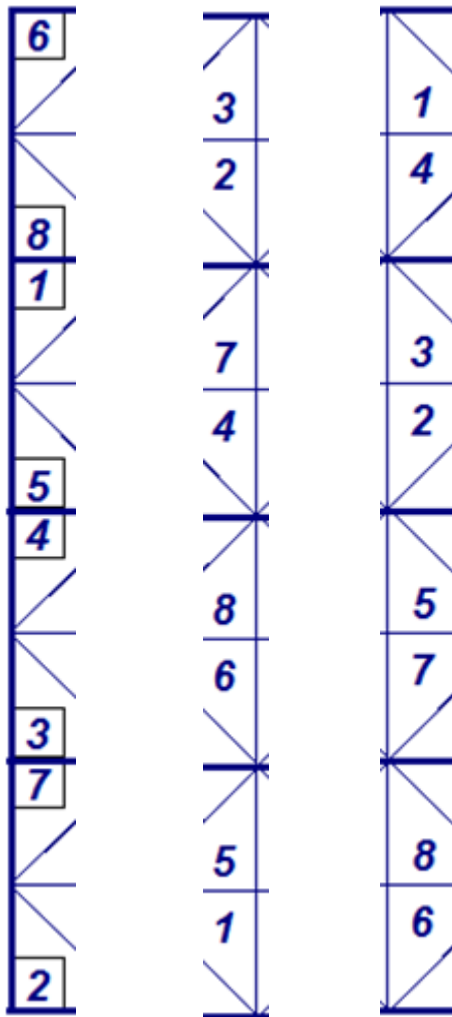

Blocks:

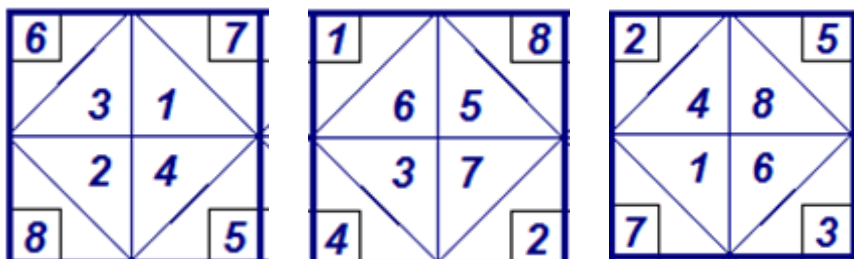



Sudoku Plaza

The puzzle looks like:

		7 1		8		5		
			5		4			2
							6	
1								
			4		2			
	2				8	1		
		6		3		7		
		1		5 6		2		
	5							6
	6		3		4			
		2 6				8		7
7								
			2					
			7					4
		3 5				4		6